

MAP

Adams & King's ADDITION to ARGENTINE

Scale 10ft = 1 Inch

A.W. Boeke,
Civil Eng.

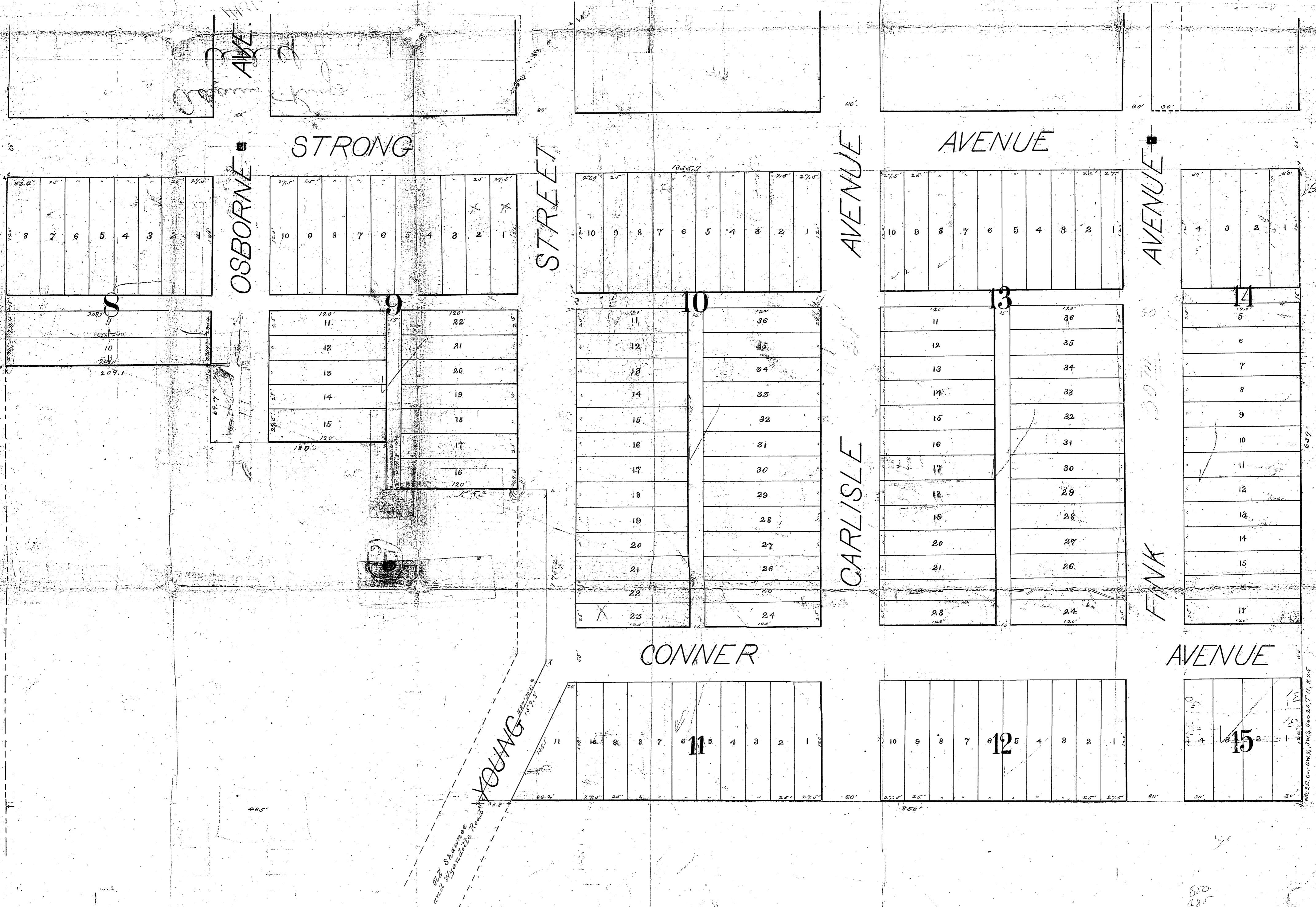

Know all men by these presents, that the undersigned owners and proprietors of the tract and parcel of land embraced in the annexed plat, situated in the County of Wyandotte, State of Kansas and described as follows to wit:

Commencing at the South East corner of the South West 1/4 of the South West 1/4 of Section 20, Town 11, Range 25, thence West 800 feet, thence North 27° 30' East 159.8 feet, thence North 175.2 feet, thence West 105 feet, thence North 54.8 feet, thence West 180 feet, thence North 69.7 feet, thence West 209.1 feet, thence North 189.8 feet, thence East 200 feet, thence South 63.9 feet to the place of commencing; do hereby lay out and plat the same into Lots, Blocks, Avenues, Streets and Alleys as shown and indicated upon said plat under the name of Adams and King's 2nd Addition to Argentine.

The parcels of ground reserved for public use as Avenues, Streets and Alleys, the names, extent and direction of all such Avenues, Streets and Alleys are designated and correctly shown upon said plat.

All lots and blocks intended for sale are set forth designated and described upon said plat by numbers, the precise length and width of each lot being thereon marked in feet and decimal parts thereof.

All Avenues, Streets and Alleys, as marked and designated thereon are hereby dedicated to the public use and purposes as such, and for no other purposes or uses.

In witness whereof said parties have hereunto subscribed their names this 26th day of January A. D. 1888

Charles Adams
Julius King
Sarah M. Adams
Caroline King

State of Kansas }
County of Wyandotte } 33

26th day of January, A. D. 1888 before me the undersigned, a Notary Public in and for the County and State aforesaid came Charles Adams, Julius King and Caroline King, all of whom are the legal heirs and assigns of the late Charles Adams, his wife and Julius King and Caroline King his wife.

Who is personally known to me to be the same person who executed the foregoing instrument, and duly acknowledged the execution of the same for himself and as co-heirs of the late Charles Adams, his wife and Julius King and Caroline King his wife. In witness whereof I have hereunto subscribed my name and affixed my Notarial Seal on the day and year last above written.

Geo. B. Watson
Notary Public

My commission expires June 25th 1891

Filed for Record
June 29 1888

U.A. Lovelace
Register of Deeds