

BOSTON PLACE ANNEX BLOCK 2

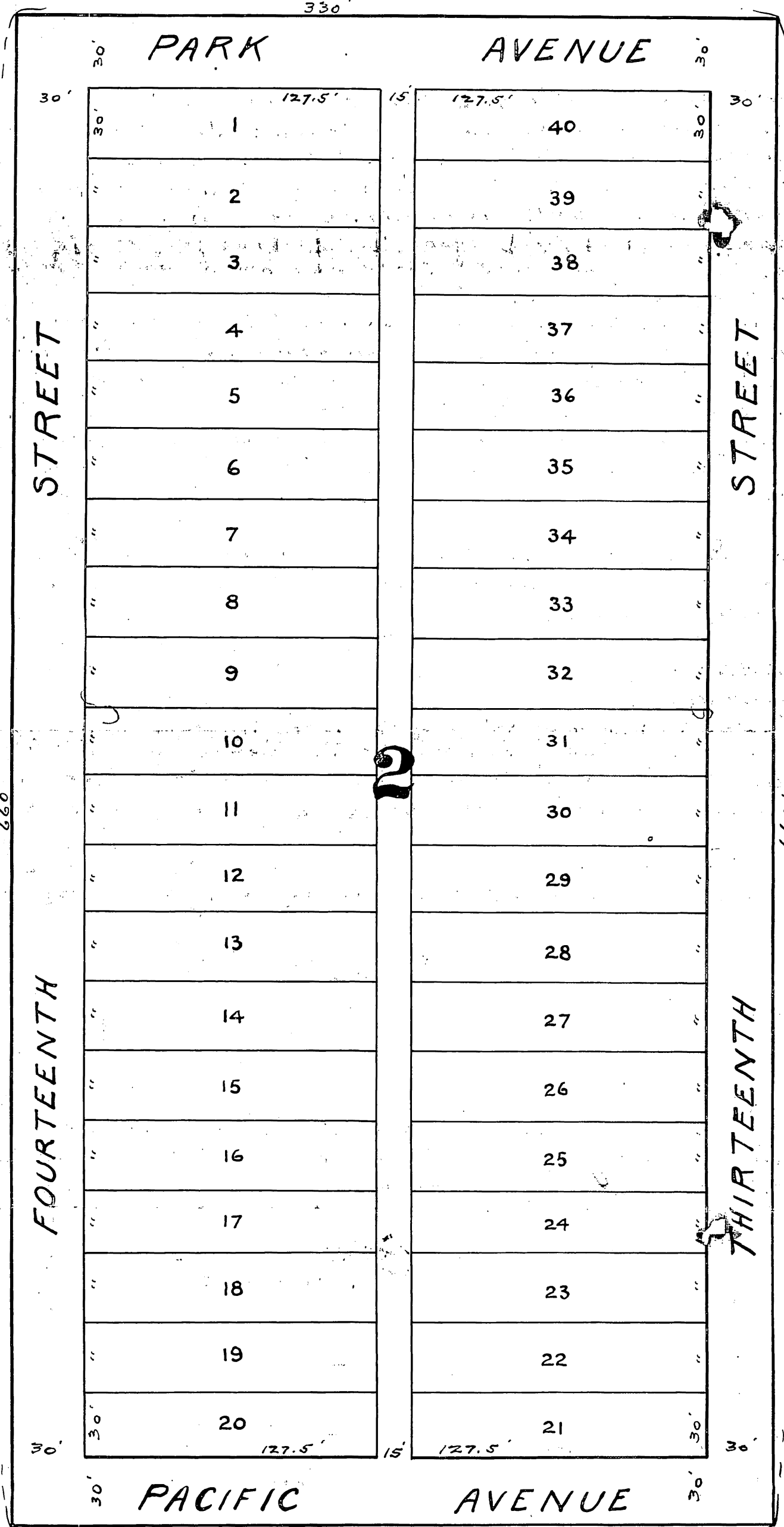

This Plat of BOSTON PLACE ANNEX covers land in Wyandotte County Kansas, described as follows, to wit:—
 Beginning at the south east corner of the north west quarter of the north west quarter of Section sixteen (16) - Township eleven (11) - Range twenty-five (25); thence north six hundred and sixty (660) feet; thence east three hundred and thirty (330) feet; thence south six hundred and sixty (660) feet; thence west three hundred and thirty (330) feet to the point of beginning.

The lands reserved for sale are designated by numbers from 1 to 40 inclusive, the exact size and dimensions of which are indicated on this plat in small figures and they will hereafter be known as lots in Block 2 of Boston Place Annex.

The parcels of ground intended for public use are streets, avenues and alleys, the name extent and direction of which are shown and they are hereby dedicated to public use as such.

IN TESTIMONY WHEREOF, E. J. Gruble the proprietor of the above described tract has hereunto subscribed his name this 4th day of August 1904.

E. J. Gruble

STATE OF KANSAS }
 County of Wyandotte } ss

Be it remembered that on this 4th day of August A.D. 1904, before me a Notary Public in and for the County and State aforesaid, came E. J. Gruble who is personally known to me as the same person who executed the foregoing instrument and duly acknowledged the execution of the same.

IN witness whereof I have hereunto subscribed my name and affixed my Notarial Seal the day and year last above written.

L. W. Carlisle
 Notary Public

My Commission expires May 14, 1908

I hereby certify that this plat of Boston Place ANNEX was approved by the Mayor and Council of Kansas City Ks. at a meeting held on the 5th day of Oct 1904.

P. J. Nugrich
 City Clerk

PT. OF BEGINNING
 SE. COR. NW 1/4 NW 1/4
 SEC. 16-T. 11-R. 25