

BOULEVARD PARK

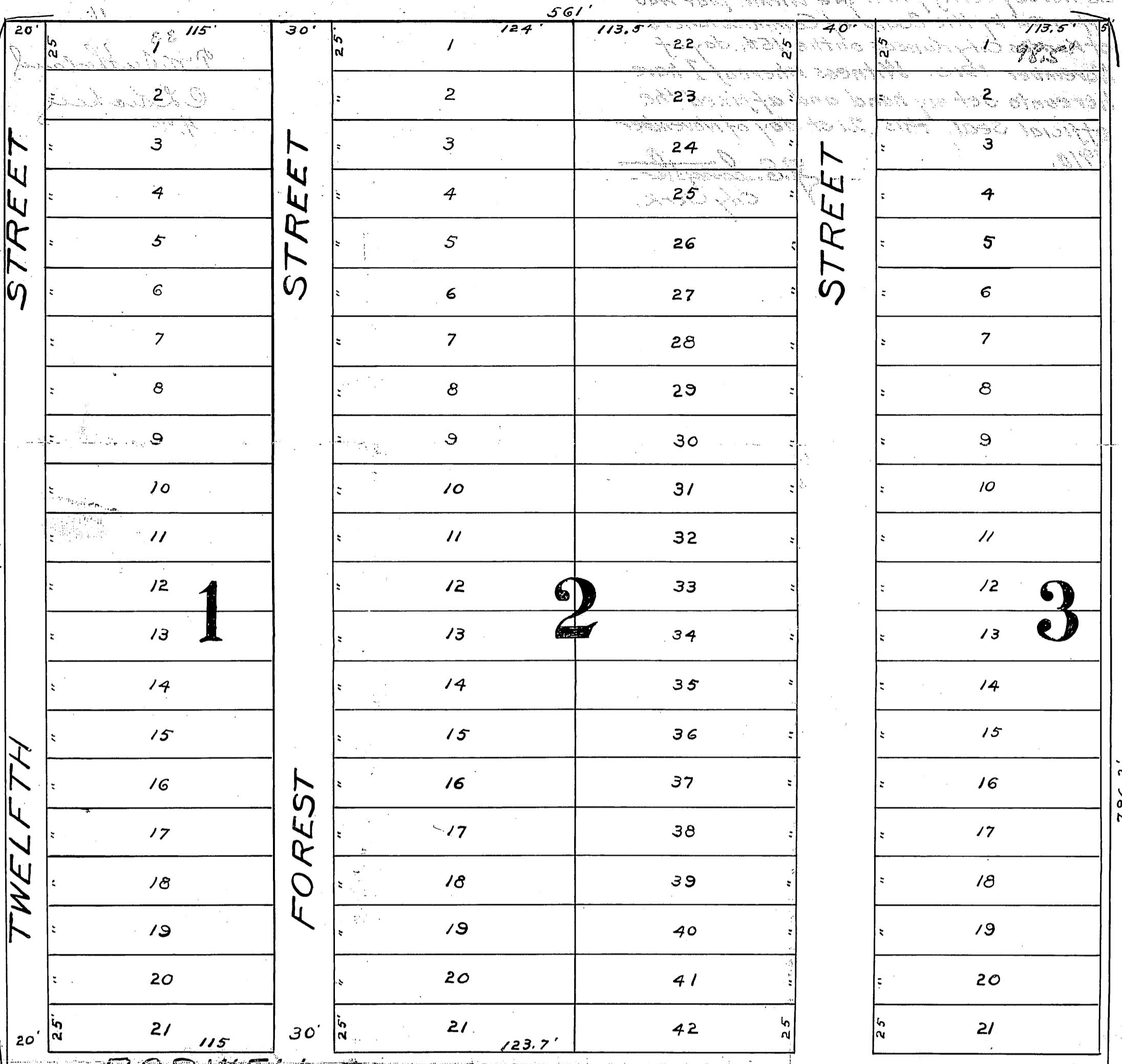

This plat of "BOULEVARD PARK" covers land in Wyandotte County, Kansas, described as follows, to-wit: Beginning at a point 698.8 feet south of the northwest corner of the northwest quarter of Section 33-Twp. 10 S.-R. 25 E.; thence south 542.5 feet; thence east 288.7 feet; thence south 253.7 feet; thence east 272.2 feet; thence north 796.2 feet; thence west 561 feet to the point of beginning; and is a re-plot of lots 1 to 9 inclusive, of Carlson's Subdivision.

The lands reserved for sale are lots and blocks, the lots being numbered in small and the blocks in large figures, the exact size and dimension of each lot being shown in feet and decimal parts of a foot. The parcels of ground intended for public use are Streets and Avenues, the name, extent and direction of which are indicated, and they are hereby dedicated to the Public as such.

In Testimony Whereof R.R. Russell, a single man, proprietor of the above described tract has hereunto subscribed his name this 4th day of November 1910.

R.R. Russell

STATE OF KANSAS }
COUNTY OF WYANDOTTE } ss.

BE IT REMEMBERED, That on this 4th day of November A.D. 1910. before me a Notary Public in and for the County and State aforesaid, came R.R. Russell, a single man, who is personally known to me to be the same person who executed the foregoing instrument and duly acknowledged the execution of the same.

IN WITNESS WHEREOF I have hereunto subscribed my name and affixed my Notarial Seal the day and year last above written.

G.P. Craig
Notary Public.

My Commission expires September 26th 1914.

