

103868

FAIRCREST

WYANDOTTE COUNTY, KANSAS.

Scale 1"=75'

12³⁰ Oct 10
J. B. Lidikay
4⁰⁰ P.M.

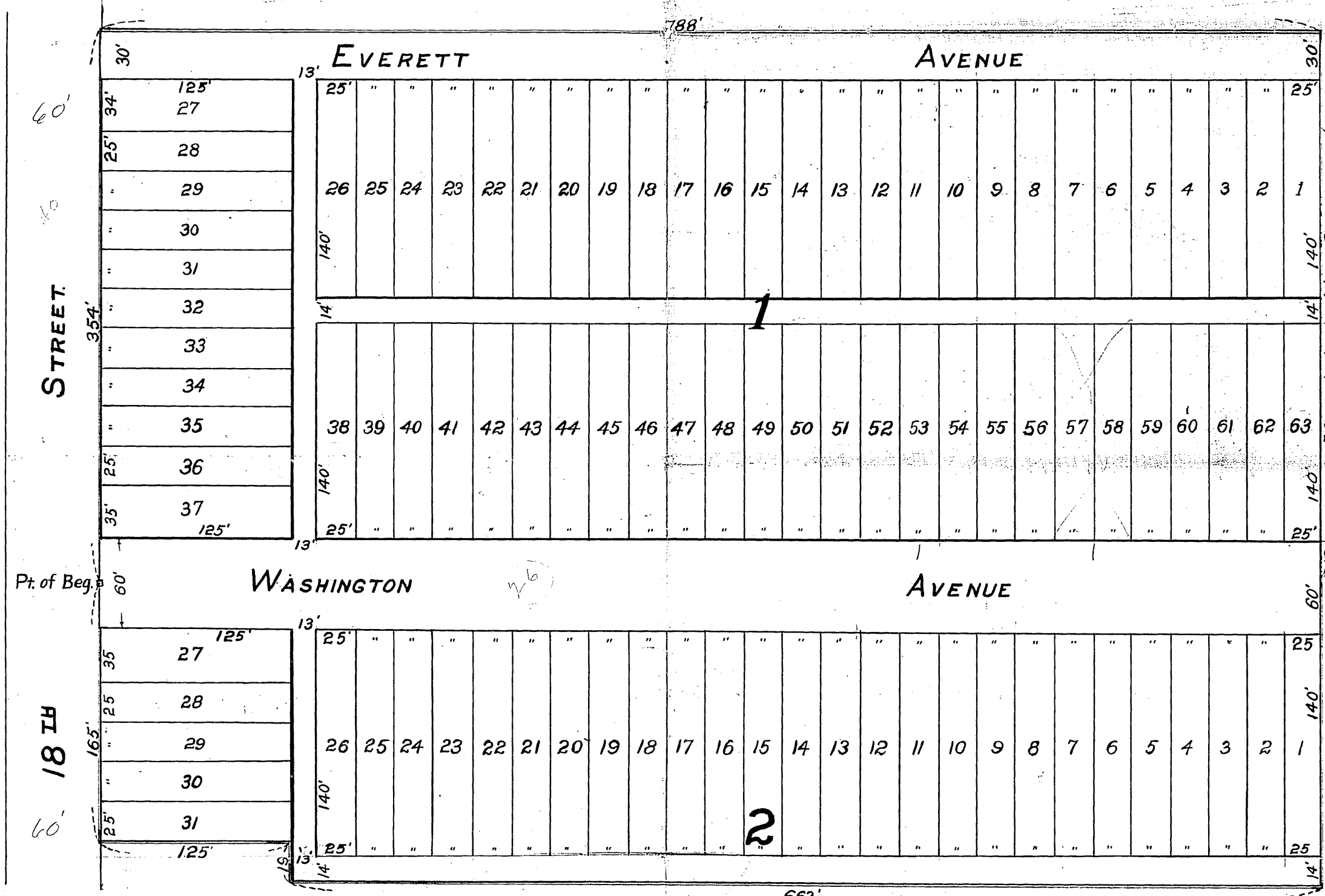

538 Lots 1-63 Commenced for 16TH ST.

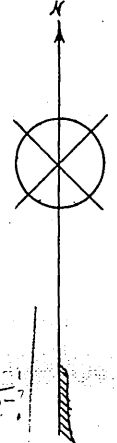

This plat of "FAIRCREST," an Addition to Kansas City, Kansas covers land in Wyandotte County, Kansas, described as follows: Commencing at a point six hundred twenty-seven (627) feet north of the southwest corner of the S.W. 1/4 of Section 4, Township 11 S, Range 25 E.; thence north three hundred fifty-four (354) feet; thence east seven hundred eighty-eight feet (788) feet; thence south five hundred thirty-eight (538) feet; thence west six hundred sixty-three (663) feet; thence north nineteen feet (19); thence west one hundred twenty-five (125) feet; thence north one hundred sixty-five (165) feet to point of beginning.

The lands reserved for sale are shown upon the above plat as lots and blocks and they are designated by small and large figures, respectively, the location and exact size of each lot being shown in feet and tenths of a foot. The parcels of ground in this addition intended for public use are streets, avenues and alleys; their names, extent and direction are shown on this plat; and they are hereby dedicated to the public for use as such.

In testimony whereof Jo B. Lidikay and Charles J. Lidikay, her husband.
and "THE BANKING TRUST COMPANY" TRUSTEE, proprietors of the above described tract of land have hereunto subscribed their names and said company has caused this plat to be signed by its President and Secretary and its common and corporate seal to be hereunto affixed this 7th day of Oct 1908.
Attest Nary M. Bedell Secretary
THE BANKING TRUST COMPANY,
By C. B. Hoffmann President.
Jo B. Lidikay
Charles J. Lidikay

State of Kansas } ss.
County of Wyandotte }
Be it remembered that on this 7th day of October 1908, before me, a notary public in and for said county came Jo B. Lidikay and Charles J. Lidikay, her husband who are personally known to me to be the same persons who executed the foregoing instrument and duly acknowledged the execution of the same.
In witness whereof I have hereunto subscribed my name and affixed my notarial seal the day and year last above written.
My commission expires July 3, 1911
David J. Smith
Notary Public.

State of Kansas } ss.
County of Wyandotte }
Be it remembered that on this 7th day of October A.D. 1908, before me the undersigned, a notary public in and for the county and state aforesaid came C. B. Hoffmann and Nary M. Bedell respectively President and Secretary of "THE BANKING TRUST COMPANY", TRUSTEE and personally known to me to be such president and secretary and the same persons whose names are subscribed to the foregoing instrument as such and acknowledged that they executed the same as the act and deed of the said "BANKING TRUST COMPANY", TRUSTEE, by the order of its Board of Directors, for the uses and purposes therein mentioned; and that the seal affixed to said instrument is the common and corporate seal of said company.
In witness whereof I have hereunto subscribed my name and attached my notarial seal, the day and year last above written.
My commission and term of office expire November 2, 1911
Julie M. Danner
Notary Public.

D. Geo. Jansen City Clerk of Kansas City Kansas do hereby certify that above plat was approved by Mayor and Council Oct 7th 1908
Geo. Jansen City Clerk