

FOREST GROVE

LASLEY & BOEKE

CIVIL ENGINEERS

SCALE 60 FT 1 1/4 INCH

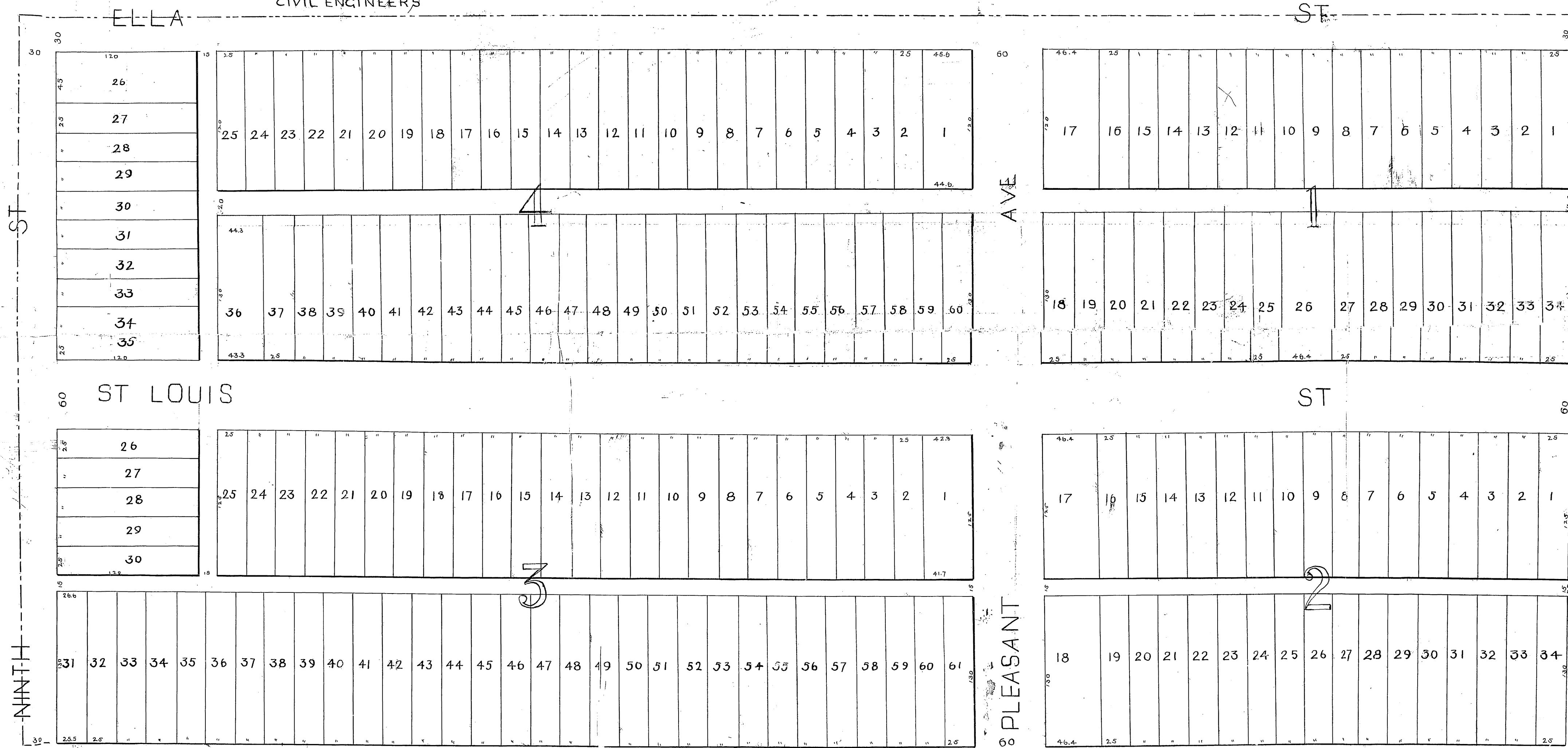

Forest Grove is embraced within boundaries Beginning at the Northeast corner of the South east quarter of Section 9 Town 11 Range 25 East, and running thence West 317 feet thence South 600 feet thence East 1312 feet thence North 600 feet to beginning in Wyandotte County, Kans.

It is subdivided into Blocks, Lots, Streets and alleys. The size of lots are given on the face of the plat, streets are named, and the widths of streets and alleys are shown in feet by figures on the plat of same, and said streets and alleys are dedicated to the use of the public as thoroughfares.

Signed
James D. Huels
Jennie B. Huels

State of Kansas }
Wyandotte County }

Personally appeared this 4th day of December 1886
James D. Huels and Jennie B. Huels who signed the foregoing declaration and duly acknowledged the execution of the same
in testimony whereof I have hereunto set my hand and seal
the day and year above written.

Signed
Commission Expires 12/22, 1889
Notary Public

Note.
Ella Street runs East and West and is 30 feet in width, St Louis Street runs parallel to Ella Street and is 60 feet wide, Pleasant Ave runs North and South and is 60 feet wide, 9th Street runs East and West and is 30 feet wide the alley running east and west through Blocks 1 and 4 is 20 feet wide all other alleys are 10 feet wide.

Lot 1 to 16 in Block 1 and Lots 2 to 25 and Lot 27 to 35 in Block 4 and Lots 26 to 30 in Block 3 bring 20 feet in width and 120 feet in length, Lot 18 to 25 and Lot 27 to 34 in Block 1 and Lot 19 to 34 in Block 2 and Lot 32 to 61 in Block 3 and Lot 37 to 60 in Block 4 bring 20 feet in width and 130 feet in length, Lot 1 to 16 in Block 2 and Lot 2 to 25 in Block 3 bring 20 feet in width and 120 feet in length Lot 17 in Block 1 bring 46 2/3 feet in width and 120 feet in length Lot 26 Block 1 bring 46 2/3 feet in width and 130 feet in length Lot 17 in Block 2 bring 46 2/3 feet in width and 120 feet in length Lot 18 in Block 2 bring 46 2/3 feet in width and 130 feet in length, Lot 1 Block 3 bring 42 2/3 feet in width at North end and 41 2/3 feet at South end and 120 feet in length Lot 31 in Block 3 bring 45 2/3 feet wide at North end and 44 2/3 feet at South end and 120 feet in length Lot 36 in Block 4 bring 44 2/3 feet in width at North end and 43 2/3 feet at South end and 130 feet in length.

Blocks are numbered from 1 to 4 in large blue figures Lots are in small black figures

State of Kansas
County of Wyandotte
Filed for record
Jan'y 18-1887 at 4:10 o'clock P.M.

60 OHIO

STREET