

FRANKLIN HEIGHTS.

Scale 160 Feet = 1 inch.

J. H. Lasey,
County Surveyor.

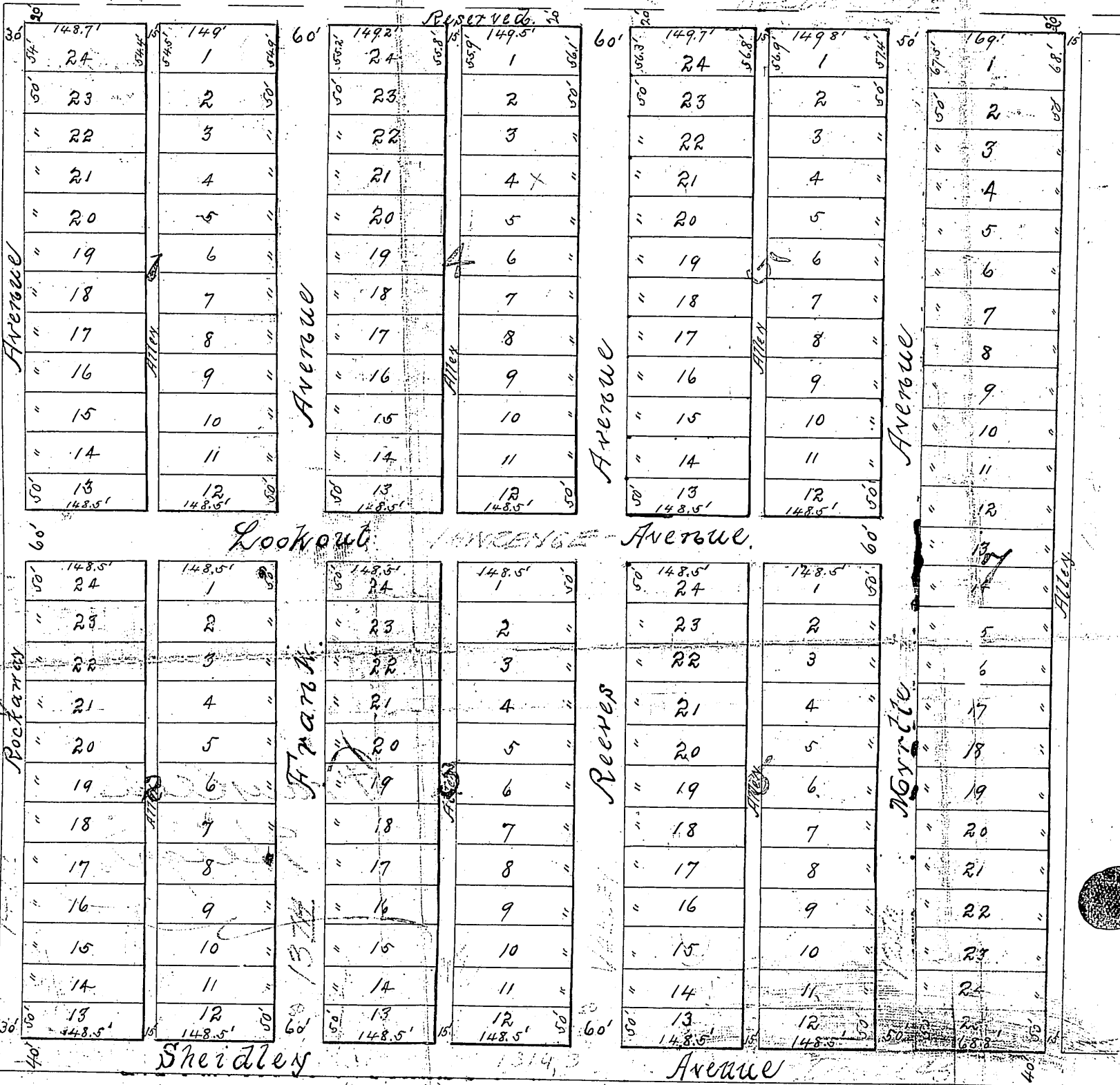

This plat of Franklin Heights covers land in Wyandotte County Kansas as follows. To wit: - Consisting of the South east quarter of the North West quarter of Section 28. Township 11. S. Range 25. E. 40 Acres in all.

The lands reserved for sale are described by numbers in Blocks and lots in Franklin Heights. The blocks being numbered with large blue figures and the lots with small black figures. The parcels of ground in the subdivision reserved for public use are Streets, Avenues and Alleys. The names, extent and direction of all such Streets, Avenues and Alleys are designated on Plat and are reserved for public purposes as such. All lots intended for sale are set forth and described by numbers in Blocks. The precise length and width of each lot in feet and decimal portion thereof is set forth on this Plat in small black figures.

In Testimony whereof we have hereunto affixed our name and seal this 5th day of Nov - AD. 1887

State of Kansas }
County of Wyandotte } S.S.

Emily Frank
C. J. Frank

Be it remembered that on this 2^d day of Nov. AD 1887 before the undersigned, a Notary Public within and for said County and State came Emily Frank and C. J. Frank personally known to me to be the same persons whose names are subscribed to the foregoing Instrument of writing and acknowledged that they executed the same as their own act and deed for the uses and purposes therein mentioned.

In witness whereof I have hereunto set my hand and affixed my Official Seal the day and year first above written
W. S. Holsinger
Notary Public

My Commission and term of Office expires on the 2^d of January AD 1891.

Filed for Record November 5-1887
 W. S. Holsinger
 Register of Deeds

PLAT BOOK 3
 Page 43