

KENSINGTON

WYANDOTT COUNTY KANSAS

Scale: 100 Ft. = 1 in.

North

J.H. Lasley, - Sur.

This plat covers land in Wyandotte County State of Kansas described as follows commencing at a point on the second standard of parallel 967.75 feet west of the northwest corner of Chelsea Place, addition as per recorded Plat thence west 185.25 feet thence south 75.7 feet thence west 807 feet thence south 1385 feet thence east 940.5 feet thence north 538 feet thence east 51.75 feet thence north to point of beginning

Dedication

The lands reserved for sale are described by numbers as blocks and lots in Kensington. The blocks being numbered with large black open figures the lots with small black figures. The parcels of land reserved for public use are streets, avenues and alleys. The names, extent and direction of all such streets, avenues and alleys are designated on this plat and reserved for public purposes as such all lots intended for sale are set forth and described by numbers the precise length and width of each lot in feet and decimal parts thereof is set forth on this plat in small black figures

In testimony whereof we have hereunto set our hands and affixed our seals this 1st day of March A.D. 1890.

S. Mather Seal
Silas E. Ratchkin Seal
Mary E. Ratchkin Seal

J. C. Durland Seal
Anna Durland Seal

1	140
2	140
3	140
4	140
5	140
6	140
7	140
8	140
9	140
10	140
11	140
12	140
13	140
14	140
15	140
16	140
17	140
18	140
19	140
20	140
21	140
22	140
23	140
24	140
25	140
26	140
27	140
28	140
29	140
30	140
31	140
32	140
33	140
34	140
35	140
36	140
37	140
38	140
39	140
40	140
41	140
42	140
43	140
44	140
45	140
46	140
47	140
48	140
49	140
50	140
51	140
52	140
53	140
54	140
55	140
56	140
57	140
58	140
59	140
60	140

STREET

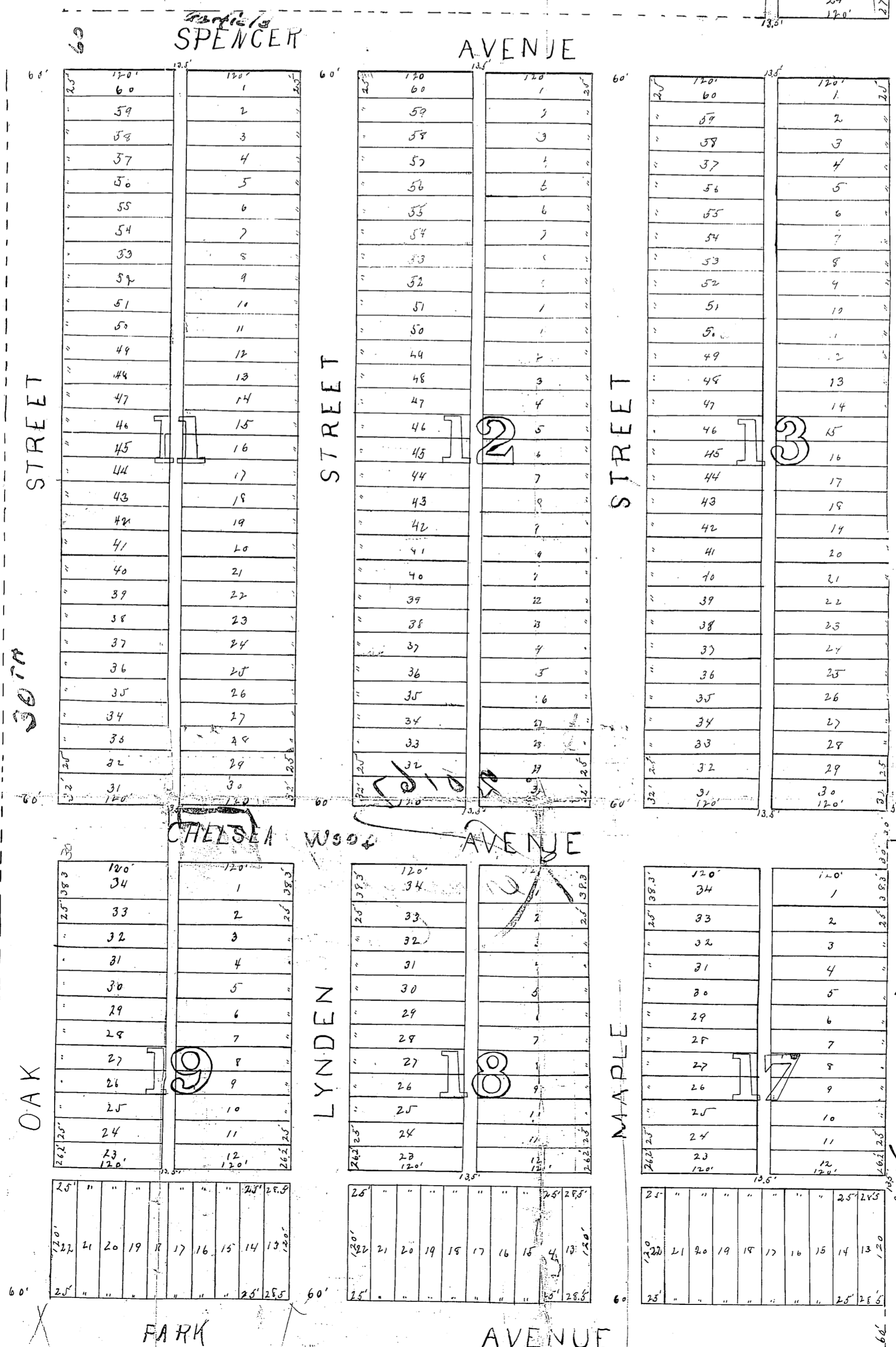

CHESTNUT

Plan Book 5 Page 39
 20167
 State of Kansas
 County of Wyandotte
 March 4 1890 at 10 o'clock
 P.M.
 W. H. Lasley
 Reg. of Deeds

State of Kansas } s.s. Be it remembered that on this 1st day of March A.D. 1890.
 County of Wyandotte }
 Before me the undersigned a Notary Public within and for said
 County and State came S. Mather and Andrew Silas E. Ratchkin and Mary E. Ratchkin
 his wife, and J. C. Durland and Anna Durland his wife
 who are personally known to me to be the same persons