

LONG BROTHERS

ADDITION TO EDGERTON PLACE

WYANDOTT COUNTY KANSAS

LONG BROTHERS ADDITION
TO EDGERTON PLACE
BOOK 2 PAGE 44

LASLEY & BOEKE

CIVIL ENGINEERS

SCALE 1" = 100'

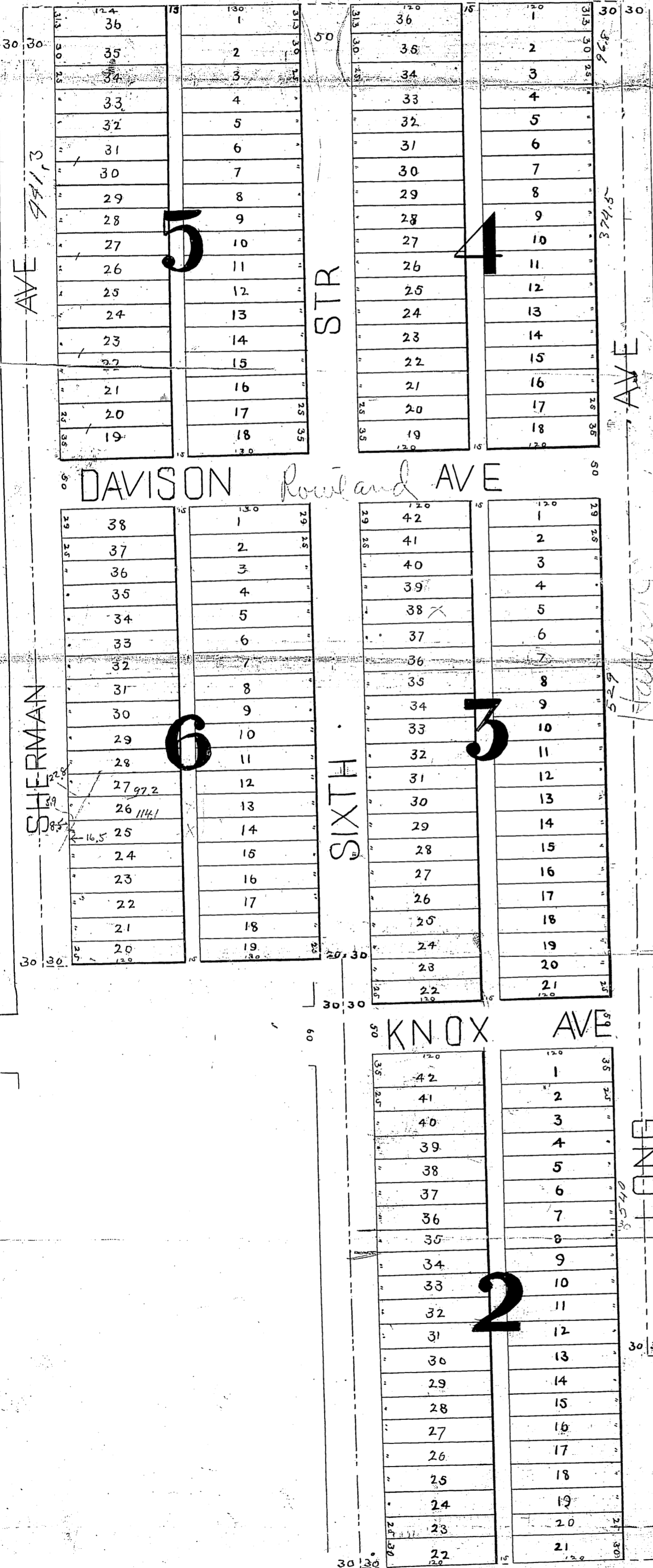

Long Brothers Addition to Edgerton Place is embraced within the boundaries, beginning at a point 96 feet west of the North east corner of the South east quarter of Section 33 Town 10 Range 25 East thence North 96 ³/₄ feet, thence West 63 ³/₄ feet thence South 100 ³/₄ feet, thence East 315 feet thence South 640 feet thence East 651 ³/₄ feet thence North 214 ⁵/₈ feet thence West 328 feet, thence North 1329 feet, to beginning

The lands here described are divided into Blocks Lots Streets and alleys Lots and blocks are designated by numbers

Streets are named and the dimensions of streets and alleys are shown by numbers on the face of the plat and they are dedicated to the public use as thoroughfares

John Song
Emma Song

State of Kansas }
County of Wyandott } ss

Personally appeared this 10th day of January 1887 before me a Notary Public in and for the State and County above written John Song and Emma Song wife of the said John Song who are known to me to be the same persons who signed the foregoing dedication and duly acknowledged the execution of the same

In witness whereof I have hereunto set my hand and seal the day and year above written

U. Hoyt
Notary Public

My Commission Expires June 9th 1890

State of Kansas }
County of Wyandott } ss

Filed for record

January 12-1887

H. H. Bridgman
Register of Deeds