

17/8

# SILVER PLACE

## WYANDOTT COUNTY

### KANSAS

Scale 100' = 1"

LASLEY & BOEKE  
CIVIL ENGINEERS

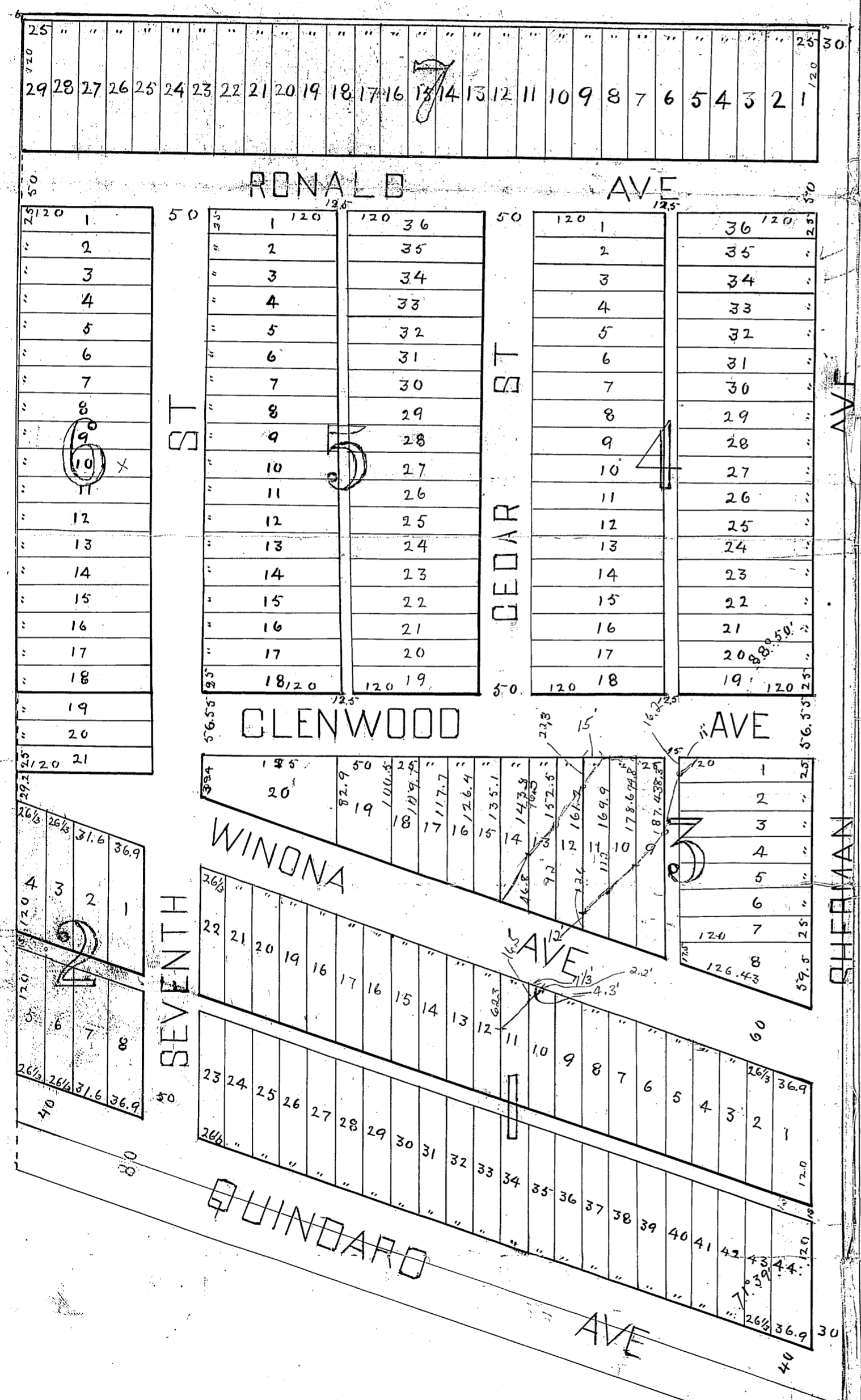

Silver Place, Wyandott County Kansas is embraced within the boundaries: -  
 Beginning 36 poles East and 57 1/2 poles South of the centre of the South East Quarter of Section 33 Town 10 Range 25 East - Running thence North 1277 feet, thence West 755 feet, thence South 1000 feet more or less to the centre of the Wyandott and Quindaro Road, thence South 71° 39' East along same to beginning

The lands here described are divided into Blocks Lots Streets and Alleys.

Lots and Blocks are designated by numbers. Streets are named, and the dimensions of streets and Alleys are shown by numbers on the face of the plat, and they are dedicated to the public use as thoroughfares.

S. B. Silver

State of Kansas }  
 County of Wyandott } ss

Personally appeared this 29<sup>th</sup> day of November 1886 before me a notary public in and for the county and state above written, S. B. Silver who signed the foregoing dedication and duly acknowledged the execution of the same.

In witness whereof I have hereunto set my hand and seal the day and year above written

D. W. Group  
 Notary Public

My Commission Expires May 7<sup>th</sup> 1890.

State of Kansas }  
 County of Wyandott } ss

Filed for record  
 Dec 3<sup>rd</sup> 1886 at 5 o'clock  
 P.M.

W. H. Bridgman  
 Reg of Recd.