

SYLVAN PARK

J. H. Lasley
Civil Engineer

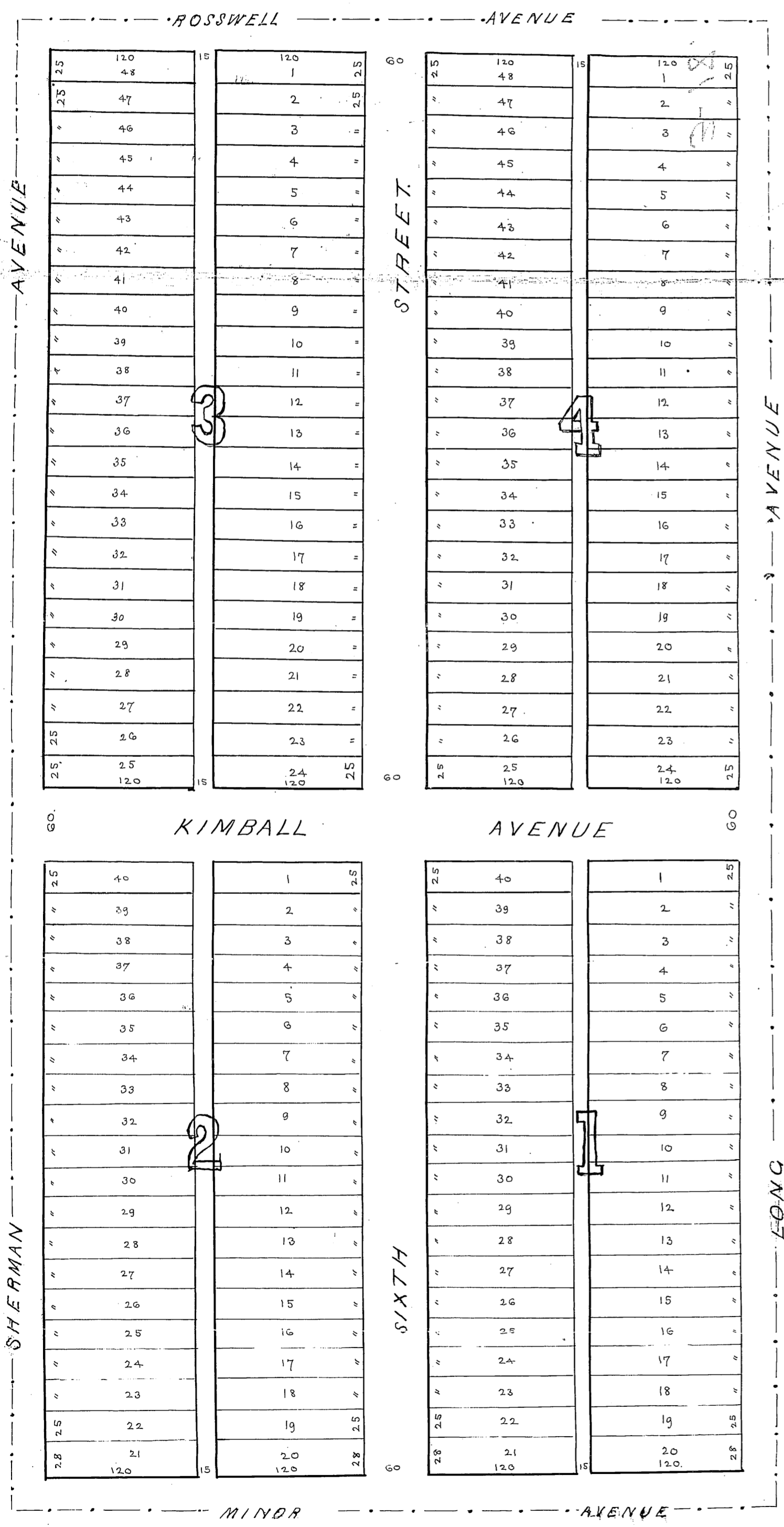

This Plat of Sylvan Park covers land in Wyandotte County Kansas bounded as follows.

Commencing at a point 96 feet West from the North East corner of the South East quarter of the North East quarter of Section 33 Township 10 South of Range 25 East of the 6th Principal Meridian in Kansas. Thence West 630 feet. Thence South 1233 feet. Thence East 630 feet. Thence North 1223 feet, to place of beginning.

The lands reserved for sale are described by numbers as Blocks and Lots in Sylvan Park. The Blocks being numbered with large figures, and Lots with small black figures. The parcel of ground in the subdivision reserved for Public use are Streets, Avenues and Alleys. The names, extent and direction of all such Streets, Avenues and Alleys are designated on Plat and are reserved for public purposes as such.

All Lots intended for sale are set forth and described by numbers in Blocks - the precise length and width of each Lot in feet and decimal portions thereof is set forth on this Plat in small black figures. In testimony whereof we have affixed our names and seals this 12th day of May 1887.

Charles H. Minor.
Helen S. Minor.

State of New York
County of Steuben

Be it remembered that on this 13th day of May 1887 before me the undersigned a Notary Public within and for said County and State came Charles H. Minor and Helen S. Minor, his wife, to me personally known to be the same persons who made the foregoing and duly acknowledged the Execution of the same in witness whereof I have hereunto set my hand and affixed my official seal on the day and year last above written. My Commission expires March 30, 1888.

Louis P. Miller
Notary Public

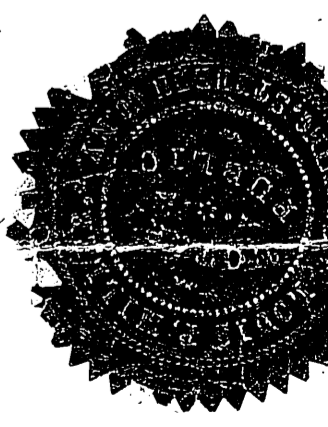

State of Kansas
County of Wyandotte

Filed for record May 20th 1887
at 1:05 o'clock P.M.

W. H. Bridgman
Register of Deeds